

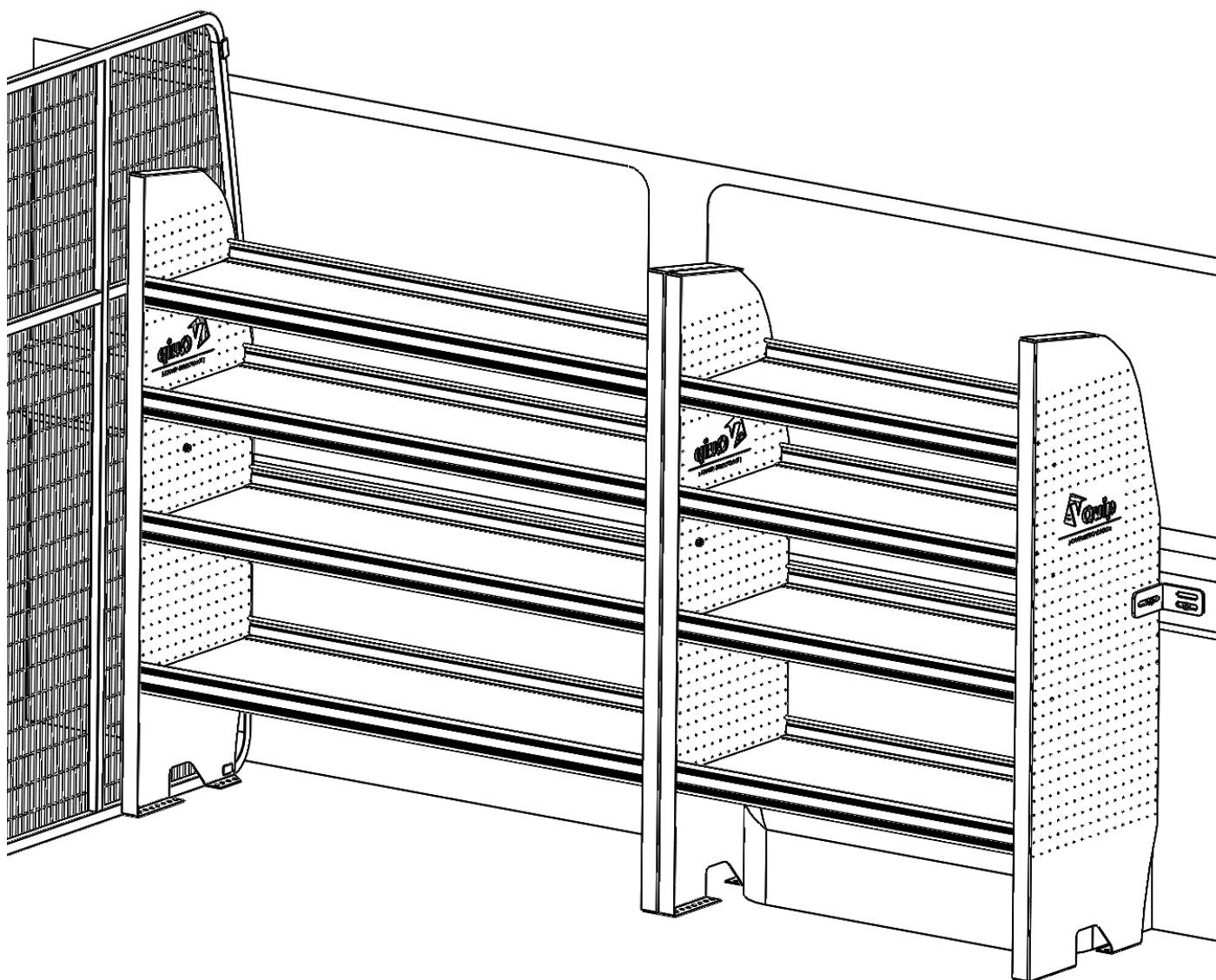

SHELVING UNIT



FITTING GUIDELINES

November 2017

VQUIP PTY LTD

22 Rocco Drive, Scoresby VIC 3179

P 1800 847 687 (free call) | **W** www.vquip.com.au

Page 1 of 10

1.0 Fitting Kit Components

ITEM NO.	PART NAME	QTY.
1	MOUNTING BRACKET 150 x 100mm (526014)	2
2	M10 X 30 BOLT	2
3	M10 WHIZ NUT	2
4	M8 JACK NUT	2
5	M8 X 30 BOLT (JACK NUT BOLT)	2
6	M10 FLAT WASHER	2
7	M10 SPRING WASHER	2
8	M8 INTERNAL TOOTH LOCK WASHER	2
9	JACK NUT TOOL	1
10	12-14 x 45 Hex SDS C3 Screw (944712.45)	4
11	DRILL GUIDE (SHORT)	1
12	DRILL GUIDE (LONG)	1
13	M8 FLAT WASHER	2

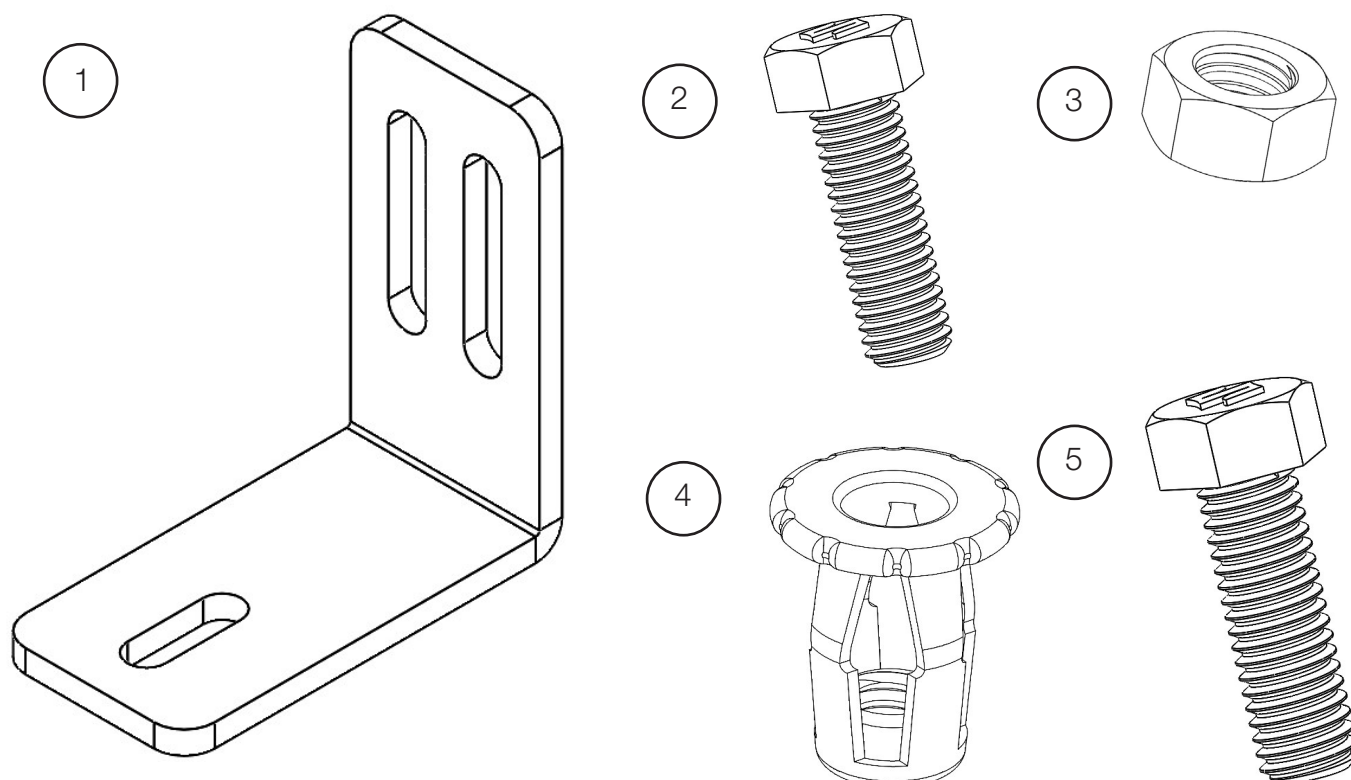

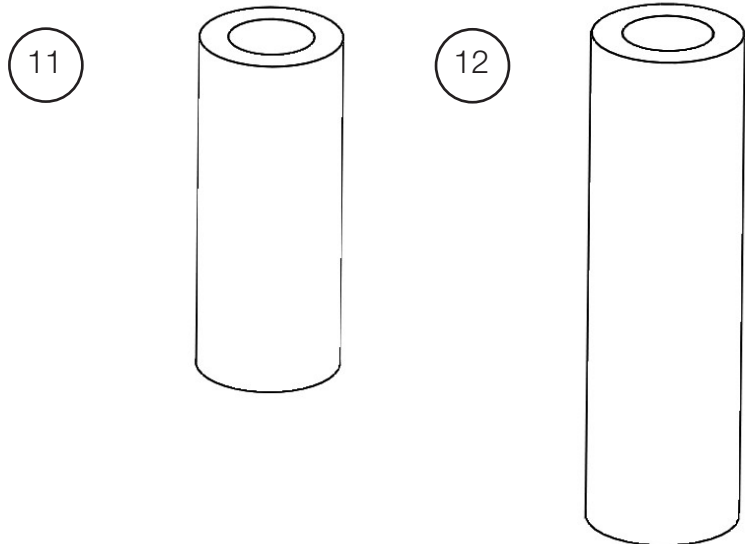
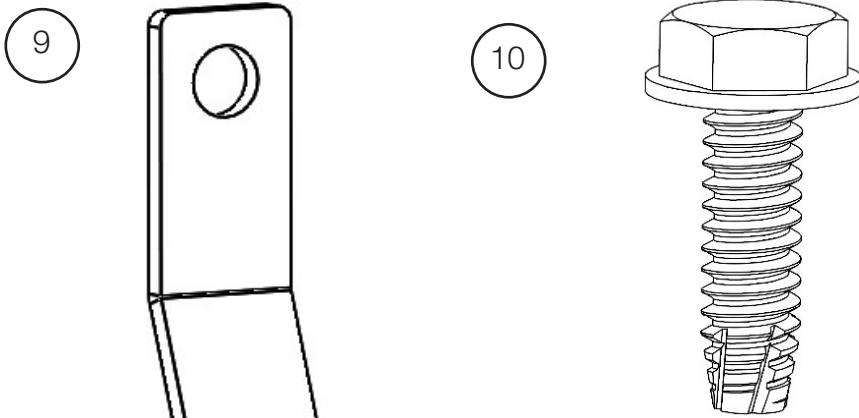
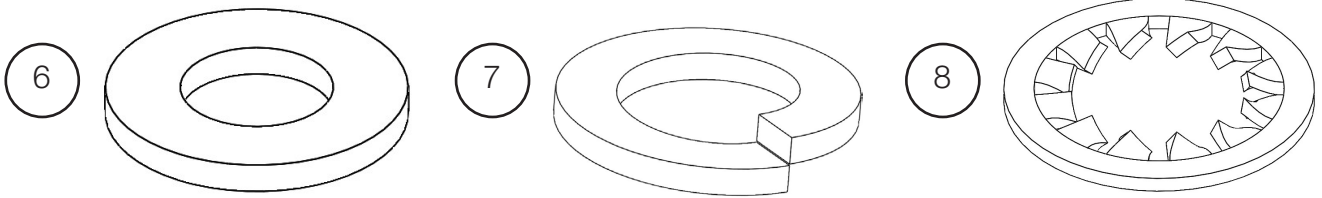

2.0 Fitment

Position your pre-assembled shelf unit in your vehicle and identify the position of any threaded mounting points. Proceed to instruction H if your vehicle has pre-existing mounting points.

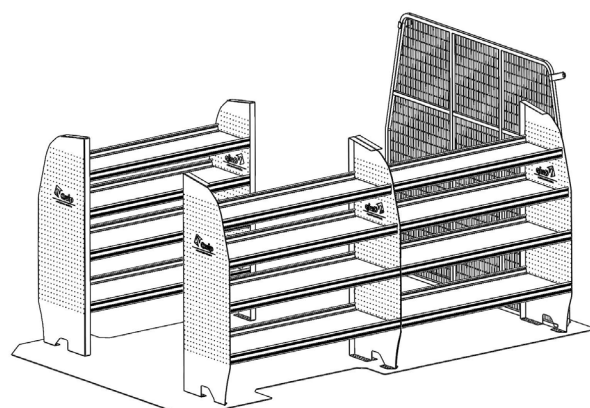
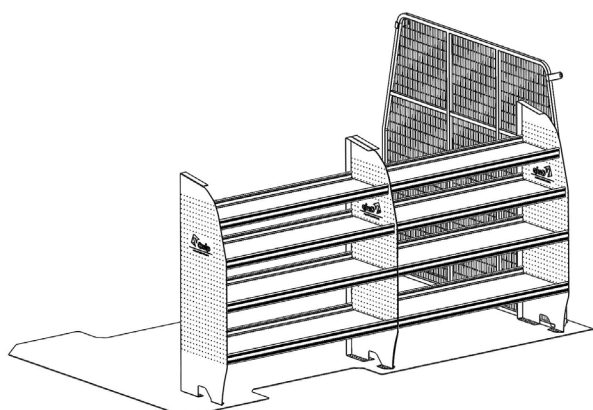
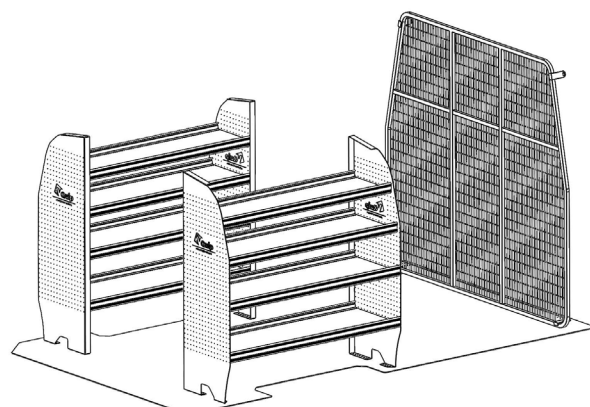
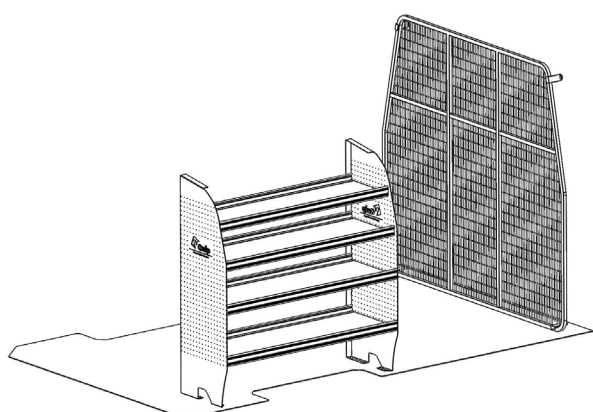

A

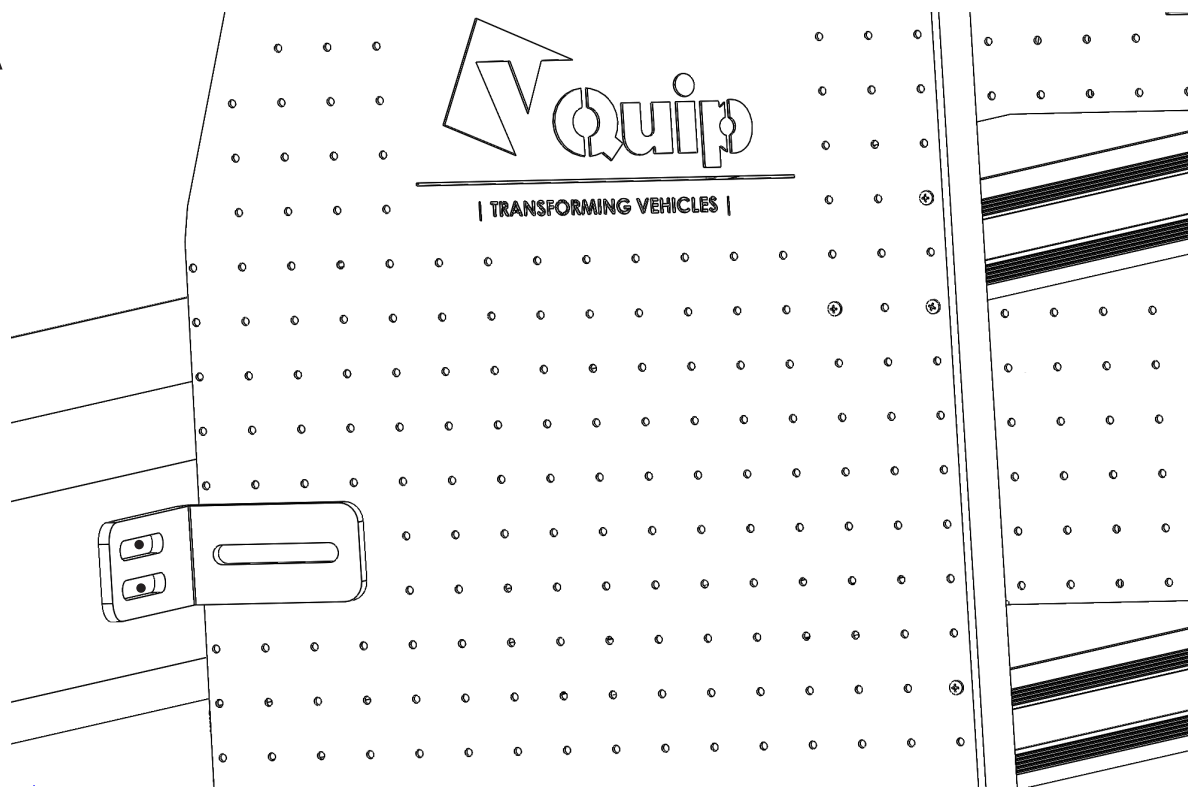

If no threaded mounting points are suitable, position the L bracket (1) over a double thickness section of sheet metal and mark the position with a marker.

If your van has a cargo barrier or partition, the front end panel should be mounted through this barrier using a bolt (2), flat washer (6) and nut (3)

B

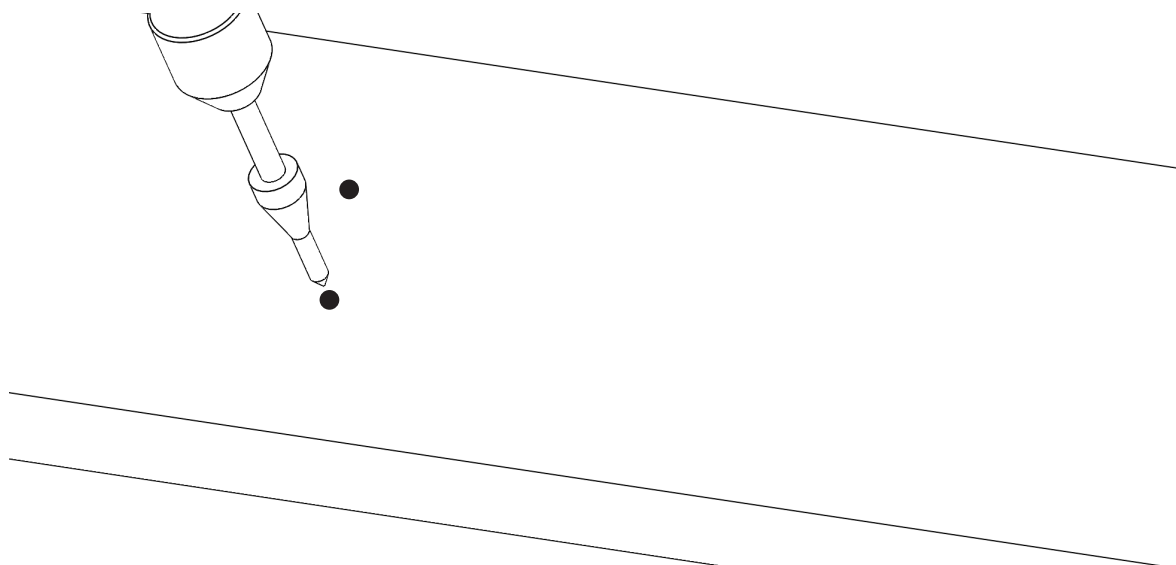

Use a centre punch to pierce the sheet metal in the position you have marked

C

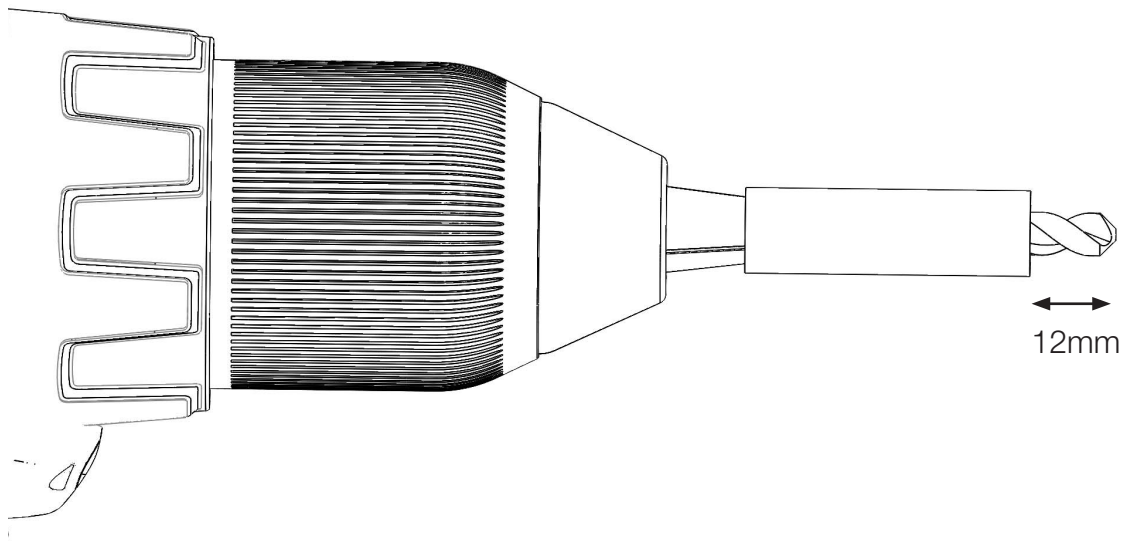

Place a 10mm drill bit with an appropriately sized drill guide ⑪ or ⑫ in your drill. Ensure that you are drilling to the correct depth so as not to damage the exterior of the vehicle

D

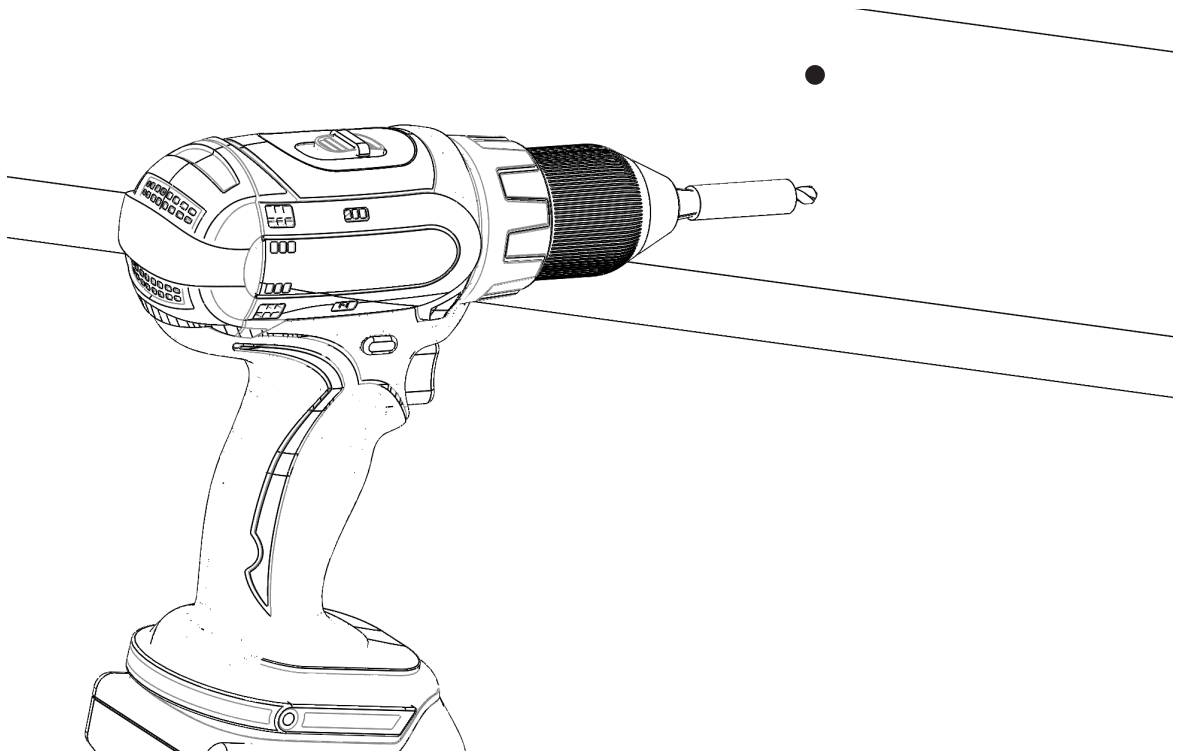

Drill a 10mm hole in the sheet metal in the position you have marked.

E

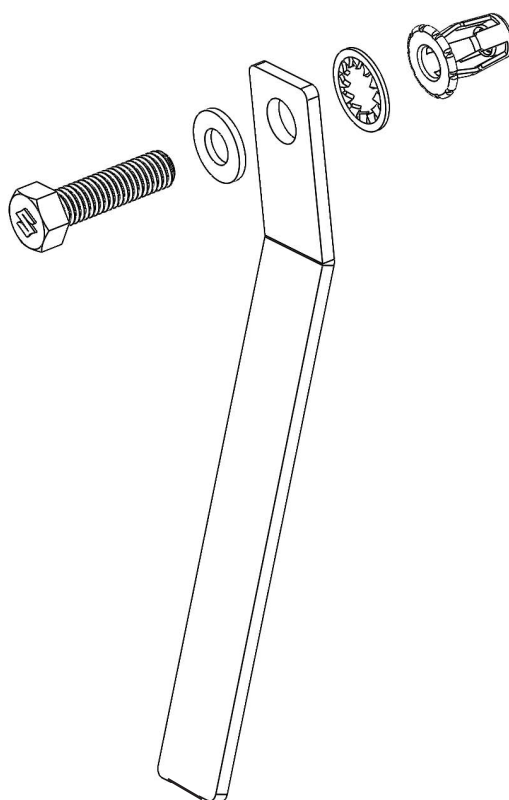

Place the flat washer (6), jack nut tool (9) and internal tooth washer (8) on a M8 jack nut bolt (5) and screw it into the jack nut (4).

F

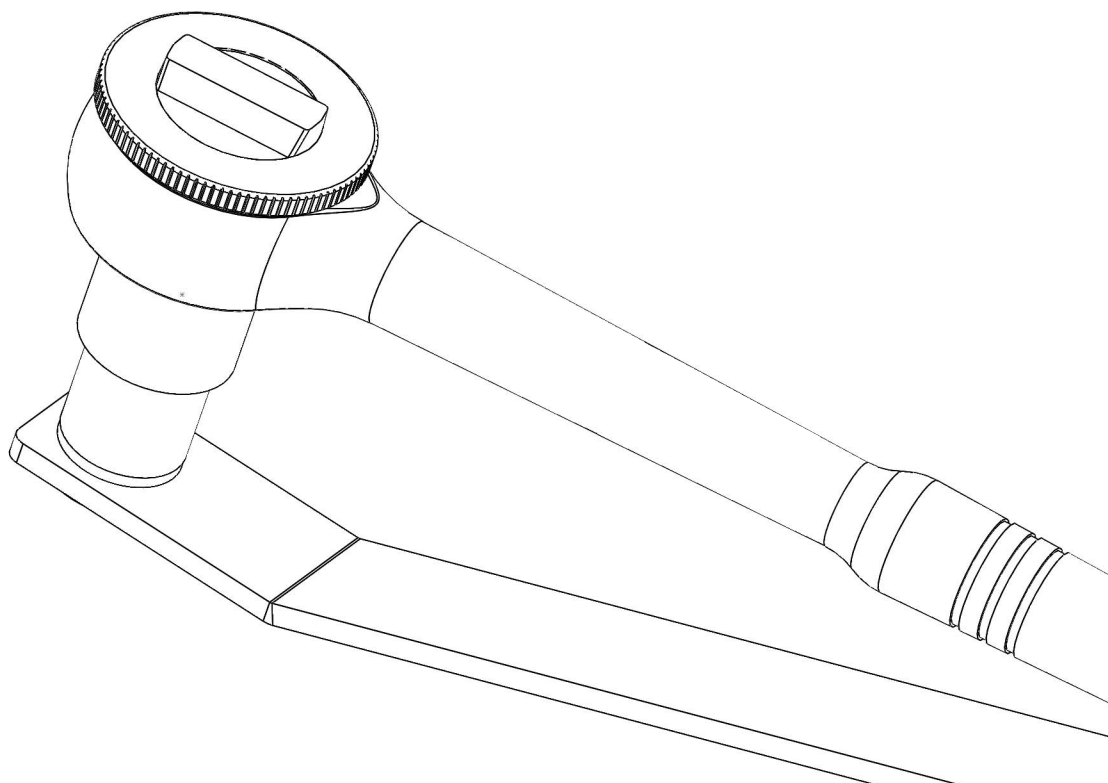

Press the jack nut into the drilled hole and tighten using a 8mm socket.

CROSS SECTION - INSTALLED IN PANEL

G

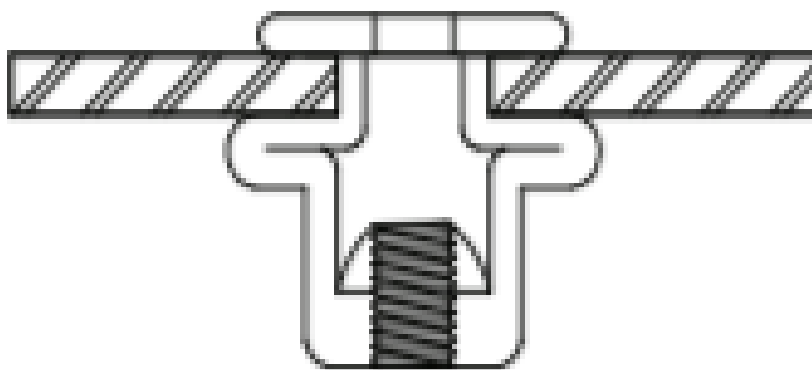

As the bolt is tightened, the body of the jack nut collapses to form a propeller shape configuration which gently grip the inside of the mounting surface leaving a permanent reusable threaded insert. Once tight, remove the bolt from the jack nut.

H

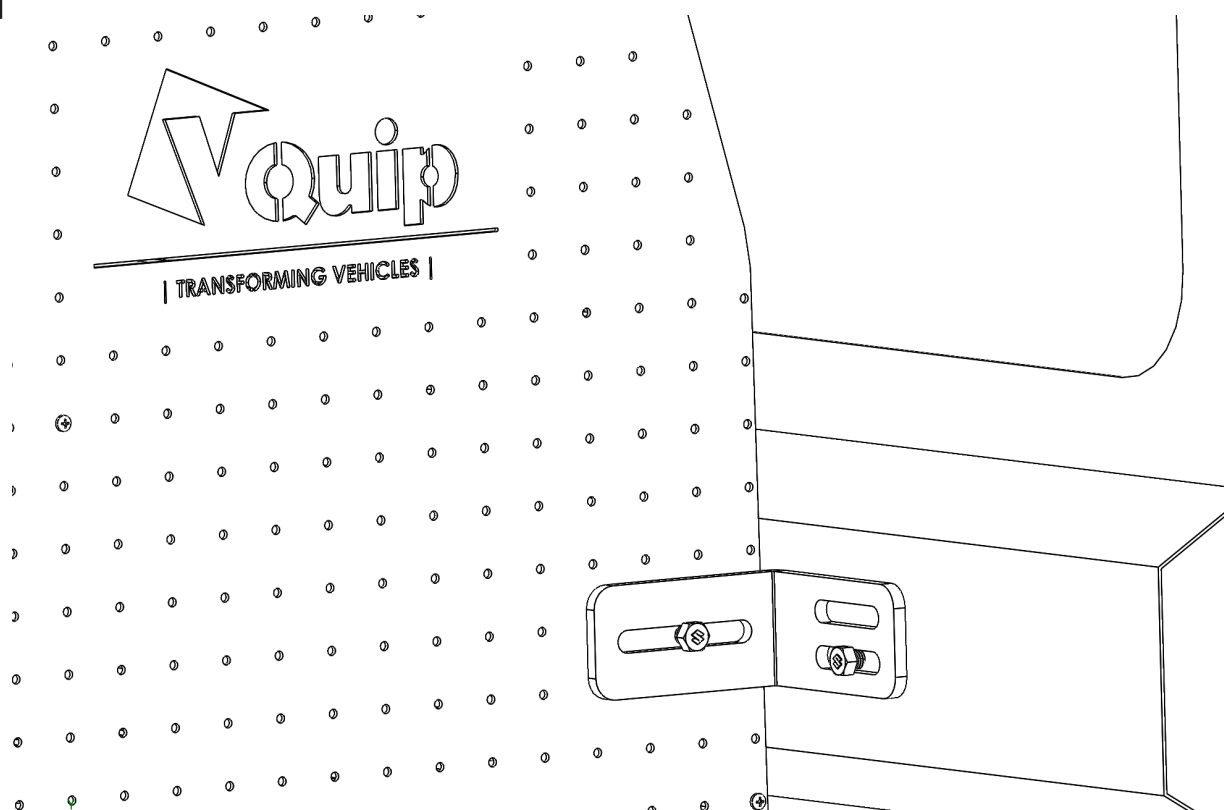

Put a spring washer (7) and flat washer (6) on a M8 bolt (6) and loosely screw one end of the L bracket (1) to the side of the vehicle. Mark the position of the corresponding hole on the side of the shelf unit. Drill a 10mm hole in the shelf end panel and put a M10 bolt (2), spring washer (7), flat washer (6) through this and secure it with a nut (3). Do not fully tighten.

I

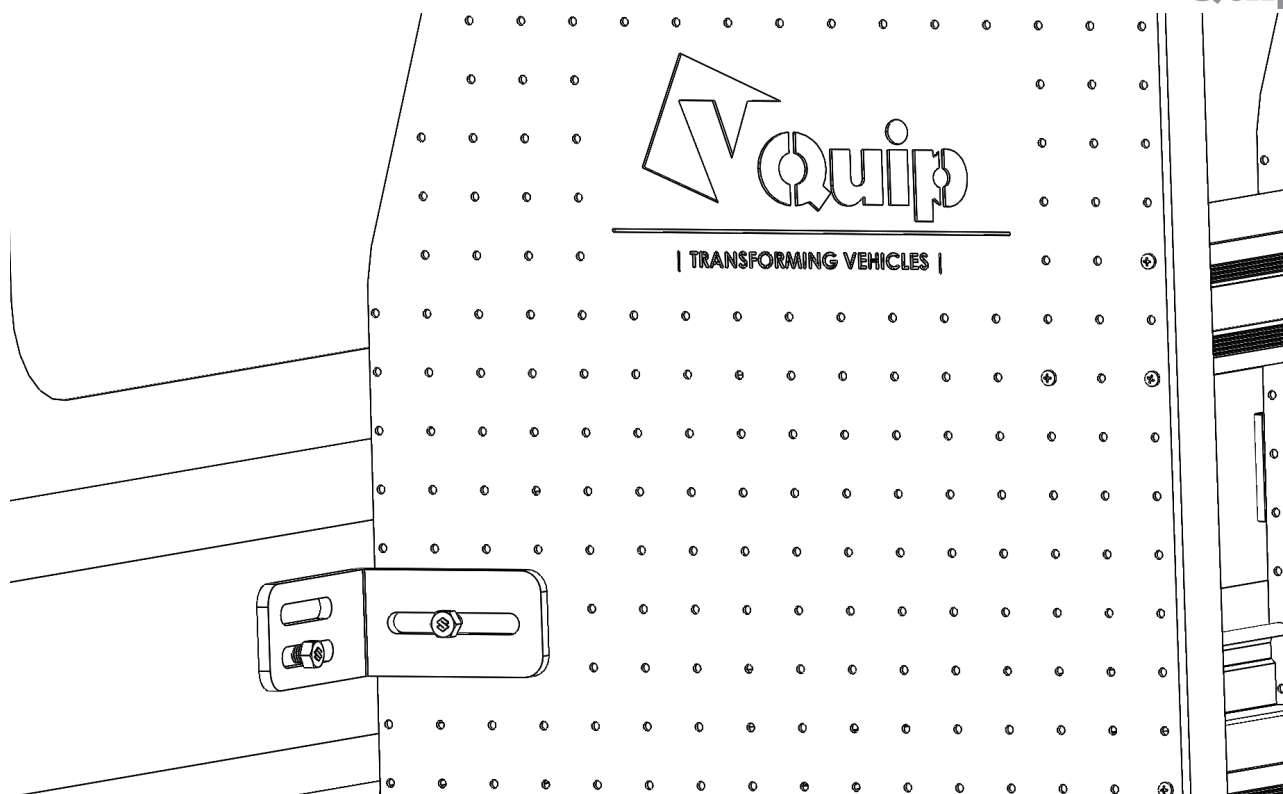

Repeat the process on the other side of the shelving unit.

J

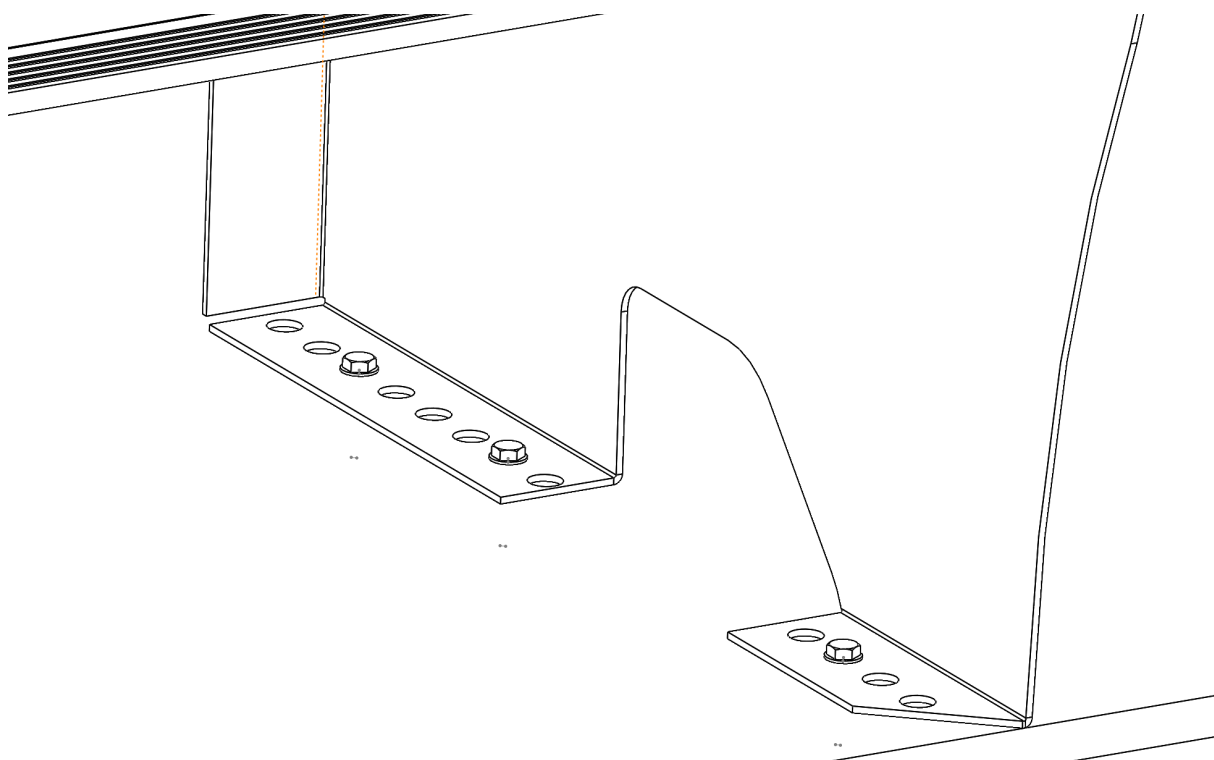

Using a socket, drive the self tapping screws (10) into the floor through the end panel bottom mounts and tighten.

K

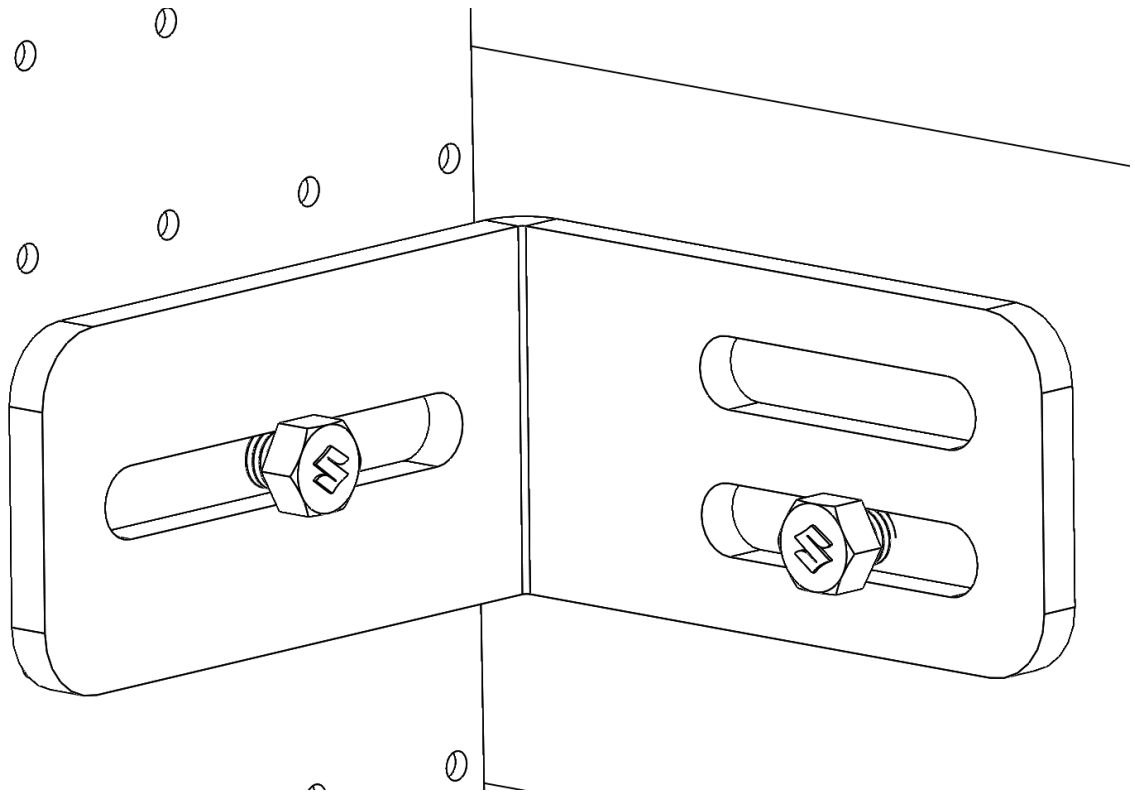

Tighten all the L Bracket bolts and check that your shelf unit is secure.